

- NOTE:
1. TRANSFORMER IS FREESTANDING IN ENCLOSURE
 2. METAL GAUGE TO CSA-C22 No. 94-M91
 3. PAINT ASA # 61 GRAY
 4. BOLTED, KNOCK DOWN CONSTRUCTION
 5. OPEN BOTTOM
 6. COVERED OPENING FOR ACCESS TO LIFTING POINTS

CSA TYPE 1 (NEMA 1)
INDOOR USE

APPROX. WEIGHT:
CORE & COIL: 3400 LBS
ENCLOSURE: 1300 LBS
TOTAL: 4700 LBS

TRANSFORMER:

KVA:

PRIMARY VOLTAGE CLASS: 25 KV

PRIMARY VOLTAGE: 27600 VOLTS DELTA

24940 VOLTS DELTA

OTHER _____

PRIMARY TAPS:

2x2.5% FCAN, 2x2.5% FCBN

600Y/347 VOLTS

480Y/277 VOLTS

OTHER _____

PRIMARY B.I.L.:

SECONDARY B.I.L.:

INSULATION CLASS:

TEMPERATURE RISE:

IMPEDANCE:

SOUND LEVEL:

125 KV

10 KV

220°C

150°C

STANDARD

STANDARD

WINDING MATERIAL:

COPPER

OR

ALUMINUM

COPPER

OR

ALUMINUM

STANDARD FEATURES:

ANTI-VIBRATION PADS

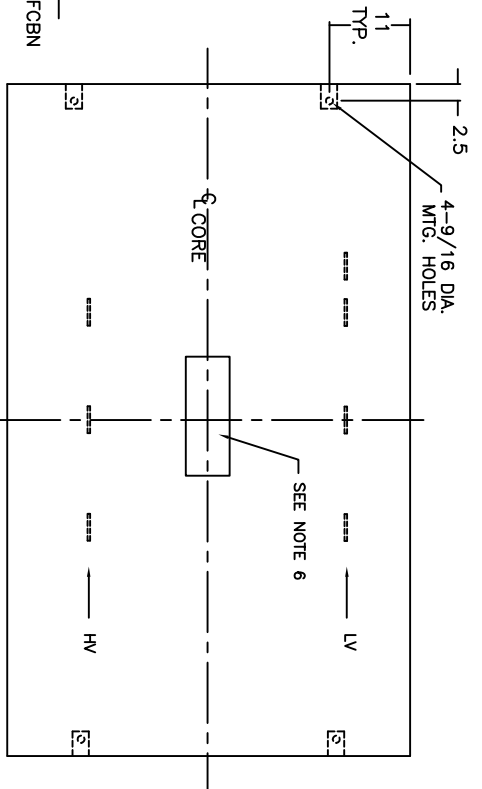

① NAME PLATE

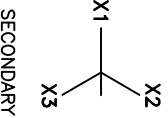
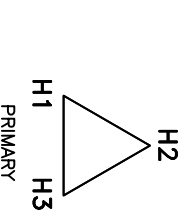

FRONT VIEW

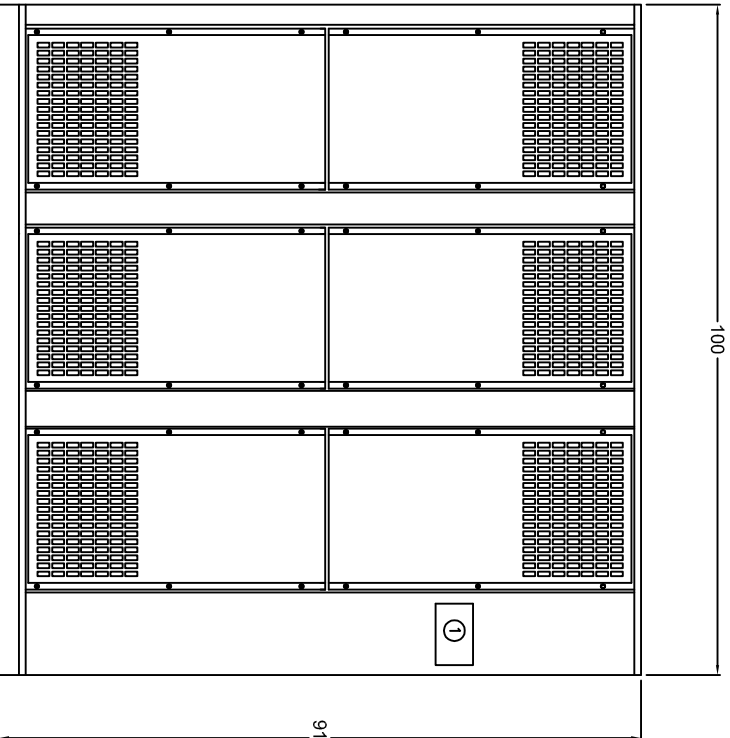

END VIEW

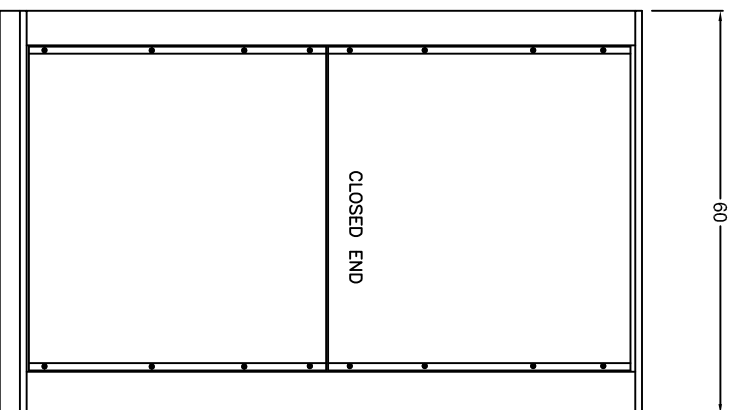

Note: Dimensions may change if units are co-ordinated with switchgear.
Dimensions are estimates. For firm dimensions contact factory.

REV.	REMARKS	BY	DATE

REX POWER MAGNETICS
DIVISION OF TRANSFACTOR INDUSTRIES INC.

SCALE: N.T.S. DRAWN BY: SARKIS DATE: JUNE 8, 1981 REV: 0

TITLE: 450KVA 25KV CLASS ENCLOSURE OUTLINE NEMA-1

DRAWING NO. 450KVA-BILL25-1