

- NOTE:
1. TRANSFORMER SITS ON ENCLOSURE BASE
 2. METAL GAUGE TO CSA-C22 No. 94-M91
 3. PAINT ASA # 61 GRAY
 4. BOLTED, KNOCK DOWN CONSTRUCTION
 5. OPEN BOTTOM
 6. COVERED OPENING FOR ACCESS TO LIFTING POINTS

CSA TYPE 3R (NEMA 3R)
INDOOR/OUTDOOR USE

APPROX. WEIGHT:
CORE & COIL: 8100 LBS
ENCLOSURE: 1250 LBS
TOTAL: 9350 LBS

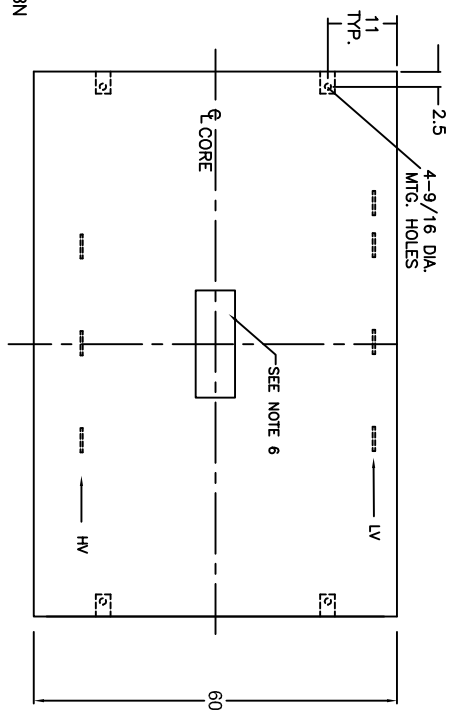

PLAN VIEW
(COVER REMOVED)

- TRANSFORMER:
KVA: 2000
- PRIMARY VOLTAGE CLASS: 1.2 KV
- PRIMARY VOLTAGE:
 600 VOLTS DELTA
 OR
 480 VOLTS DELTA
 OR
 OTHER _____
- PRIMARY TAPS:
 2x2.5% FCAN, 2x2.5% FCBN
- SECONDARY VOLTAGE:
 240V/138 VOLTS
 OR
 208V/120 VOLTS
 OR
 OTHER _____

- PRIMARY B.I.L.: 10 KV
 SECONDARY B.I.L.: 10 KV
 INSULATION CLASS: 220°C
 TEMPERATURE RISE: 150°C
 IMPEDANCE: STANDARD
 SOUND LEVEL: STANDARD

- WINDING MATERIAL:
 COPPER
 OR
 ALUMINUM
- TERMINAL MATERIAL:
 COPPER
 OR
 ALUMINUM
- STANDARD FEATURES:
 ANTI-VIBRATION PADS

VECTOR DIAGRAM

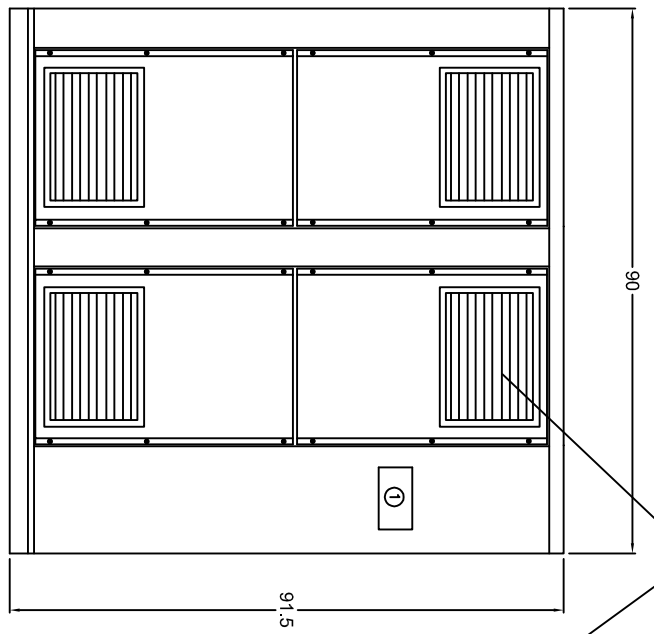
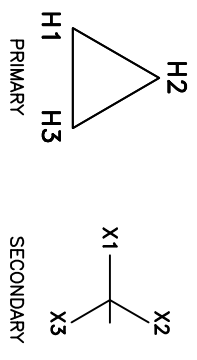

FRONT VIEW

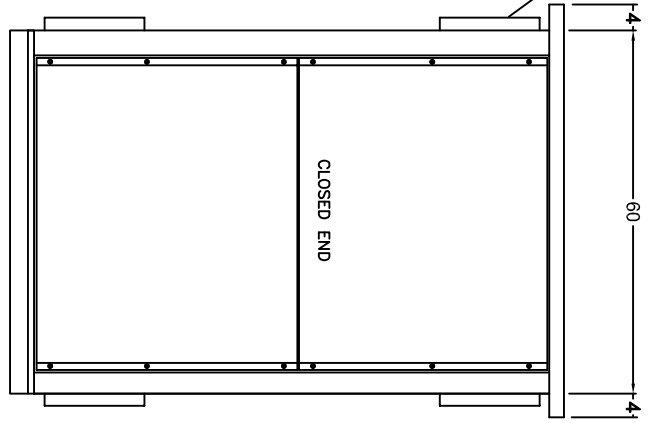

SIDE VIEW

① NAME PLATE

Note: Dimensions may change if units are co-ordinated with switchgear.
 Dimensions are estimates. For firm dimensions contact factory.

REV.	REMARKS	BY	DATE

REX POWER MAGNETICS
 DIVISION OF TRANSFORMER INDUSTRIES INC.
 SCALE: N.T.S.
 DRAWING No. 2000KVA 1.2KV CLASS ENCLOSURE OUTLINE
 NEMA-3R
 DESIGNED BY: SARKIS DATE: MAY 12, 09
 DRAWN BY: DMM DATE: MAY 12, 09
 CHECKED BY: DATE: 0

DRAWING No. 2000KVA-BIL10-3R